

# Rear Clip & Suspension Options

Art Morrison Enterprises offers no less than seven clip/suspension options to provide the desired traction and handling for virtually any application. The clips are CAD-engineered to the

exact year/make/model vehicle and the mandrel-formed .120" wall tubing is fixture-welded to assure proper alignment of suspension components.

## TRIANGULATED 4-BAR

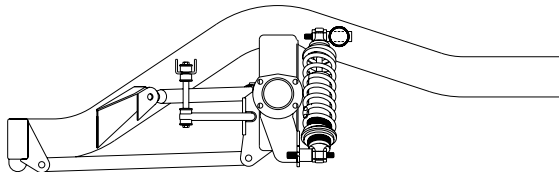

Primarily for street rods and Pro Touring (G machines).  
Factory-welded 2" x 4" subframe.....**1,885.00**

## LADDER BAR

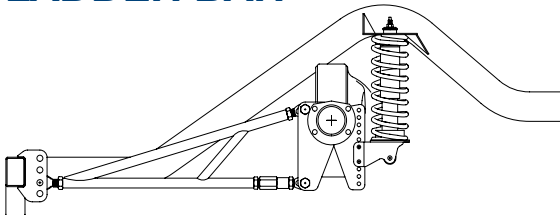

Primarily for drag race cars and Pro Street applications.  
Factory-welded 2" x 3" subframe..... **\$1,180.00**  
Factory-welded 2" x 4" subframe.....**1,660.00**

## AIR SPRING

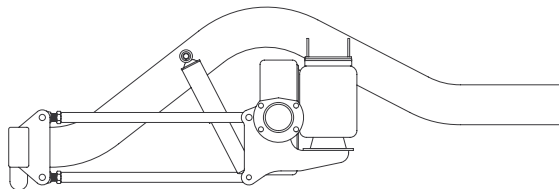

Primarily for street rods and pickup trucks.  
Factory-welded 2" x 4" subframe..... **\$1,675.00**

## FOUR LINK

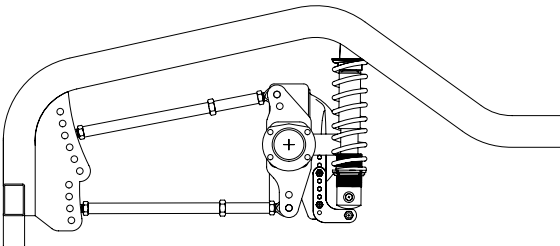

Primarily for drag race cars and Pro Street applications.  
Factory-welded 2" x 3" subframe..... **\$1,180.00**  
Factory-welded 2" x 4" subframe.....**1,660.00**

## FOUR BAR

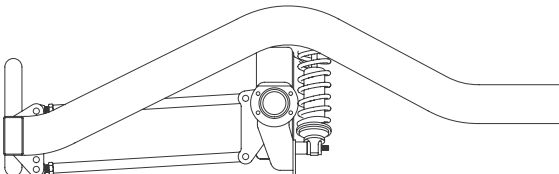

Primarily for street rods and pickup trucks.  
Factory-welded 2" x 4" subframe..... **\$1,660.00**

## THREE LINK

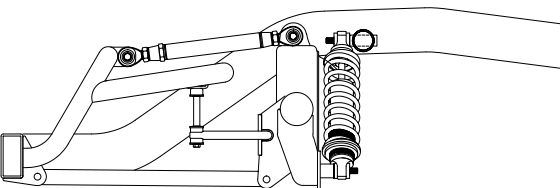

Primarily for street rods and Pro Touring (G machines).  
Factory-welded 2" x 4" subframe..... **\$2,545.00**

## MULTI-LINK I.R.S.

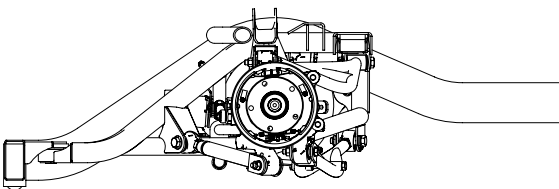

Primarily for street rods and Pro Touring (G machines).  
Factory-welded 2" x 4" subframe..... **\$2,365.00**